

1930 PINE STREET

SAN FRANCISCO, CA 94109

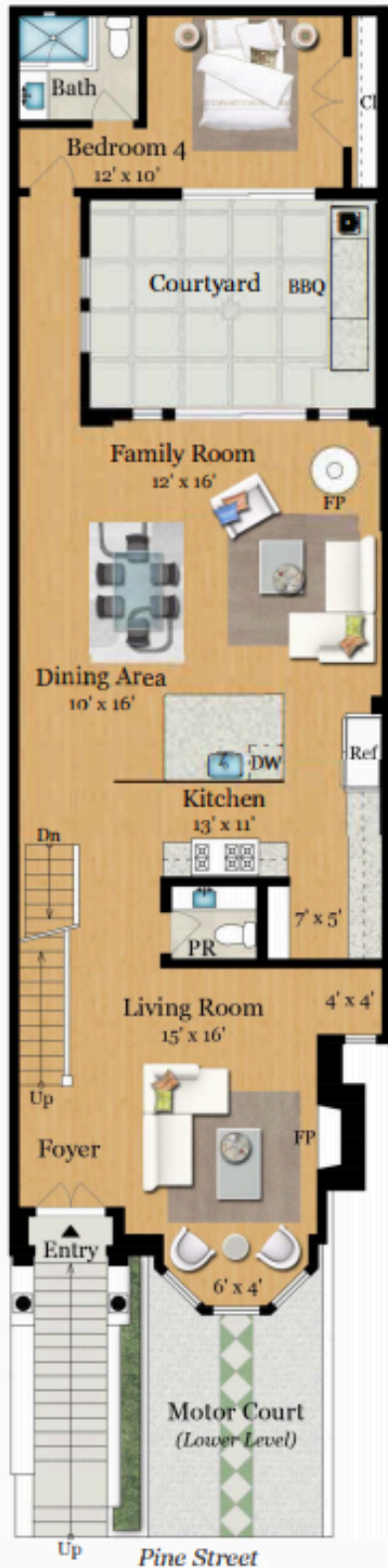

MAIN LEVEL
1,410 SQ FT



UPPER LEVEL
1,100 SQ FT

Estimated Total Finished Square Footage: 3,170 SQ FT
Above-Grade: 2,510 SQ FT Below-Grade: 660 SQ FT
Plus 450 SQ FT 2-Car Garage on Lower Level
Calculated per ANSI Standard Z7652003.

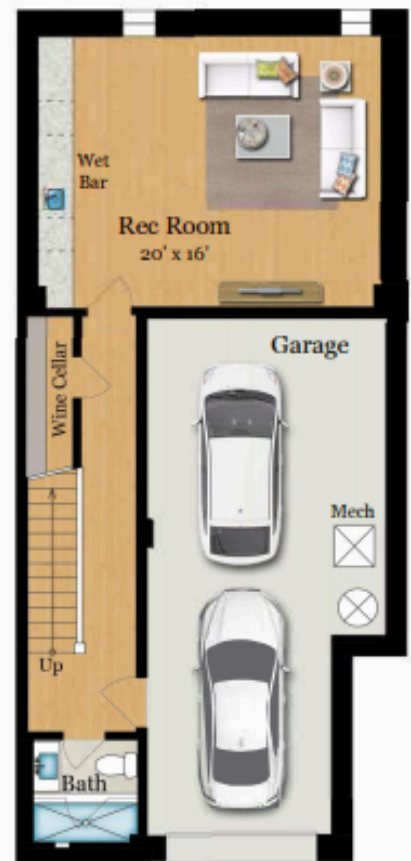

LOWER LEVEL
660 SQ FT

Rendering by Floor Plan Visuals.
All measurements are approximate. While deemed reliable, no information on these floor plans should be relied upon without independent verification.